



GOLD SEEKER



GOLD & METAL DETECTOR



UIG DETECTORS

WWW.UIGDETECTORS.COM

SHOP DETECTORS

TEL : +1 206-401-9788

WEB : <https://shopdetectors.com/>

EMAIL : contact@shopdetectors.com



GER DETECT

WWW.GERDETECT.DE

INDEX

• Page 1: Critical Warning
• Page 2: Over view
• Page 3: Definition of the main unit buttons & leds
• Page 4: The device feature and specifications
• Page 5,6,7: Gold seeker device parts connection
• Page 8-10: Gold seeker device operation steps
• Page 11: Gold seeker device using warnings
• Page 12: Gold seeker coil comparison (depth & sensitivity)
• Page 13,14: The device parts and accessories



CRITICAL WARNING

- Please be sure that all precautions taken against risks.
- Do not use your device while it is raining or on an extremely wet floor.
- Turn on your device after you make sure that all parts are in place and connected.
- Make sure that the battery is fully charged before you start the search.
- If the battery starts to give a peep sound, close the device, and recharge the battery.
- when the battery will almost run out of power the device will close automatically.
- It is recommended to read the user manual before start working on the device to understand everything and to avoid mistakes doing the search.
- After the device start to make a sound and turn off automatically put the battery on charge and do not try to start the device without charging the battery.
- If the green light & the red light on the charger is on, it means the battery is full, and if the battery empty, the red light will be on only.
- Be aware of high voltage resources, and do not use any charger other than the original charger that comes with the device.
- Main unit of the device is under warranty against all electronic breakdowns for two (2) years, any damages caused by user errors (laying open the main unit, hits, harms, etc.) are not within this warranty.
- Battery, headphones, charger, are also not within this warranty.
- You should follow the instructions in this user manual strictly to minimize the faults and to use your device correctly.

We wish you the best of luck in your search...

Dear customer,

“Thank you for choosing **GOLD SEEKER”**

- ✓ This product enables you to detect gold nuggets, precious metals, treasures buried in the ground.
- ✓ The world's first-of-its-kind device that operates on a pulse induction system to detect internal treasures such as gold nuggets, precious metals and ancient coins.
- ✓ Gold seeker is designed to operate in all kinds of terrain and in the most difficult climatic conditions.
- ✓ Gold seeker can skip all kinds of minerals and mineral rocks using automatic calibration technology.
- ✓ The device depth is up to 3.5 meters under the ground.

DEFINITION OF THE MAIN UNIT BUTTONS & LED

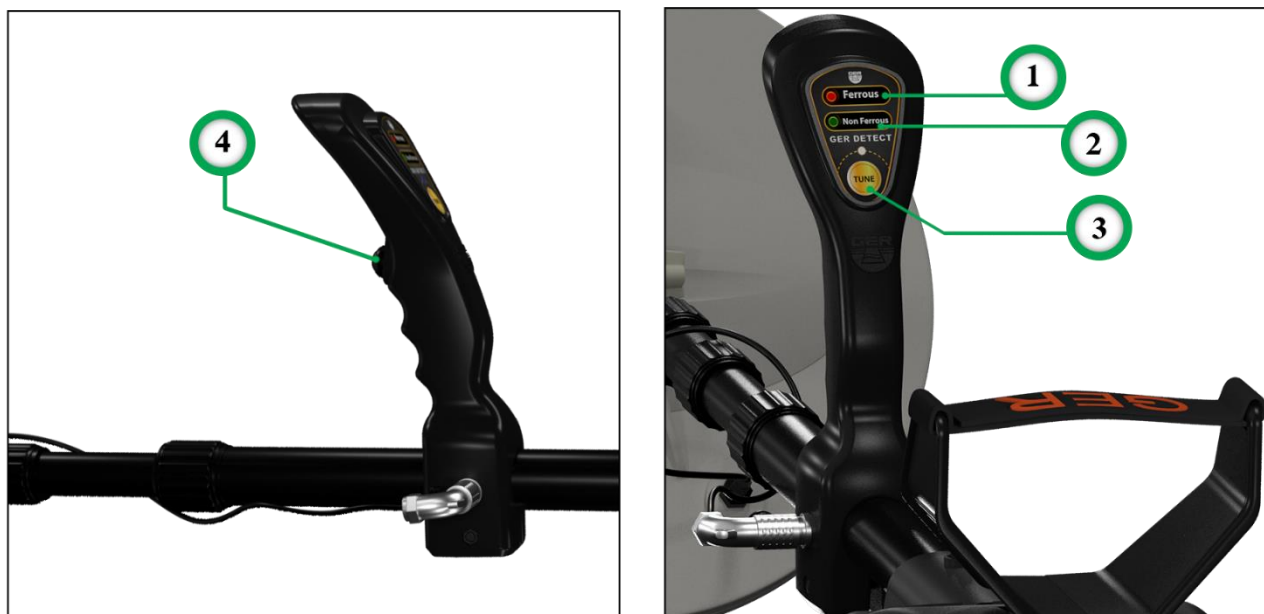

- 1- **Ferrous Led**: it will light ON if the target is non-precious metal (for example **IRON**).
- 2- **Nonferrous Led**: it will light ON if the target is precious metal (for example **GOLD**).
- 3- **Tune button**: which allow you to axis more depth and increases the discrimination range if detect deep target, **1 push to turn ON & 1 push to turn OFF**.
- 4- **Calibration button**: to calibration the device with the ground.

DEFINITION OF THE BATTERY BUTTON & LED & ENTRIES

- 1- **Test button**: to test the percentage of the battery power.
- 2- **Percentage Led**: to display the battery Percentage left.
- 3- **ON / OFF button**: to turn on or turn off the power.
- 4- **USB entries**: allow you to charge any external device (mobile – tablet – etc....).
- 5- **Charger entries**: to charge the battery.

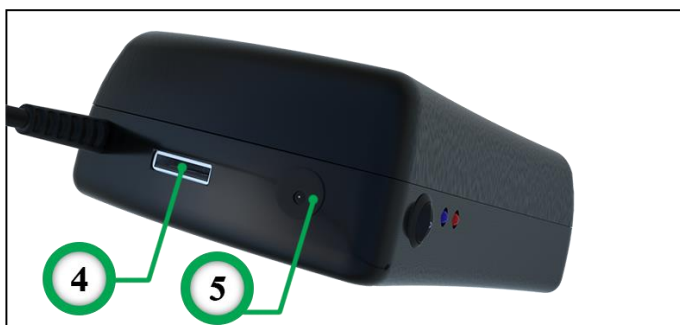

THE DEVICE FEATURE AND SPECIFICATIONS



- 1- A unique feature of this device is its ability to calibrate with the ground to ensure that it is not affected by any signals resulting from moisture in the soil, mineral rocks, or land containing mineral salts or solid ground.
- 2- This product has been developed by adding the feature of ground induction which is capable of generating (Eddy Current) (transmitter and receiver) When the device is working, it sends a signal to the search coil (Double D Coil) which, in turn, generates a spiral current signal (Eddy Current). This will create spiral waves amplifies to more than 1000 pules per second to assist the device to cover greater depths as well as analyze the signal from the target to determine if the metal detected is precious or non-precious.

THE GOLD SEEKER DEVICE PARTS CONNECTION



THE GOLD SEEKER DEVICE PARTS CONNECTION

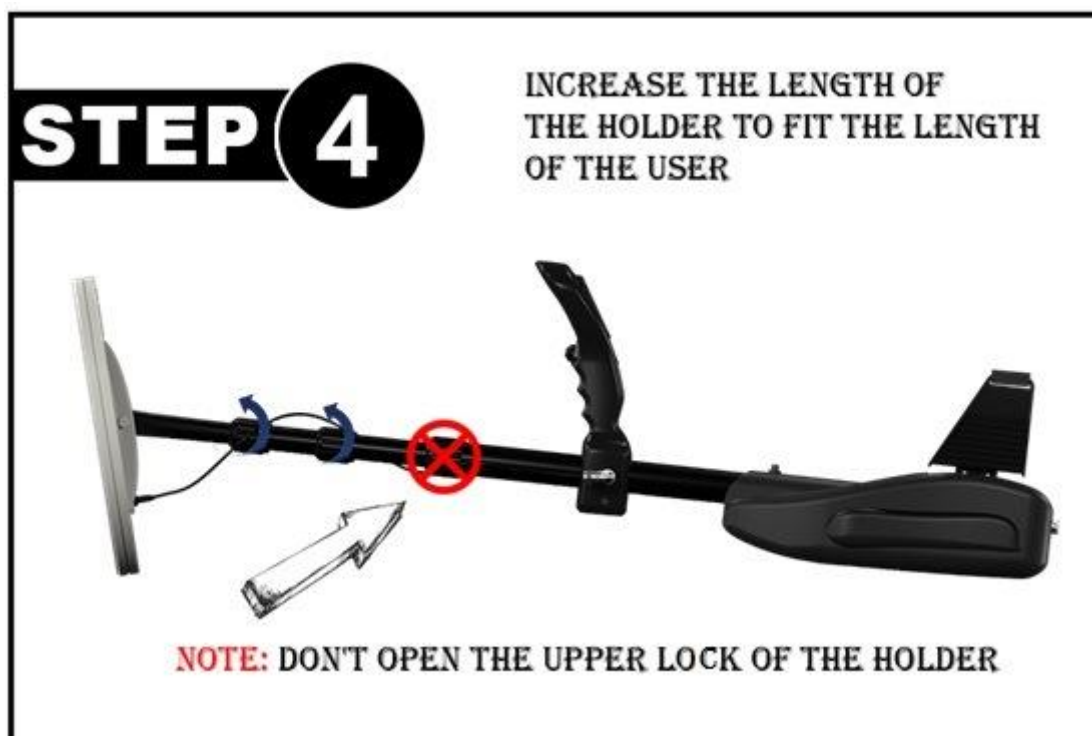

THE GOLD SEEKER DEVICE OPERATION STEPS

STEP 5

CONNECT THE SEARCH COIL CABLE BY PUSHING THE CONNECTER TOWARDS THE ENTRANCE



Switch on the device by pressing on ON / OF button on the battery side.

When you hear a peep sound and The red light goes on This Indicate That the battery Is out of Power and you need to Recharge it.

Adjust the search coil to be parallel with The ground by moving the coil up and down Gently will Touching the ground

ROTATE



THE GOLD SEEKER DEVICE OPERATION STEPS

NOTE: the device search coil should be up in the air will
Starting the device to complete the calibration process correctly

When you start the device, wait until the sound stops and put down the search coil to the ground surface while keeping pressing the calibration button.

Keep moving the device up and down Interactively until the sound stops.

Note: the distance between the highest point and the lowest point will be calibrating it's (up 15 cm / down 4 cm)

The final stage of calibration the sound will be very low so you should down the distance between highest point and the lowest point It's (up 10 cm / down 2 cm).

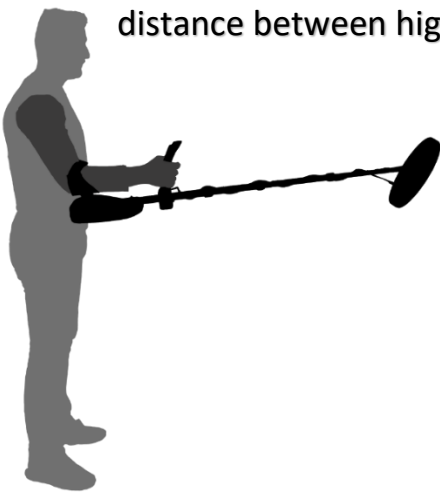

After finishing the calibration, leave the device up in the air and if it is giving you a continuous sound you should do the calibration process again.

Note: The target must be buried underground for many years so that by the time and interaction with the soil's composition, an ionic field will be formed which will help prospectors to detect the target.

Therefore, testing the device on metals laid on the ground or newly buried under the ground will not show the real capacity and functionality of this device to detect the target or to reach larger depths.

The reason for that is that the ionic fields are radiations from gold and other metals that have been in the ground for a long time and have intersected and interacted with the soil and the nature of the earth as well as having been regulated with magnetic fields north and south – These features do not actualize in gold and other metals when they exist on the ground or newly buried.

THE GOLD SEEKER DEVICE OPERATION STEPS



NOTE: Don't press the calibration button while working on the device.

Note: if you press the calibration button while working, you should re-calibrate the device

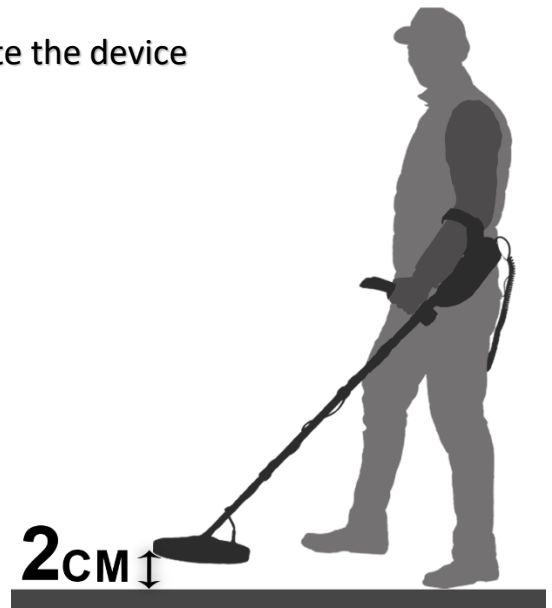

The distance between the search coil and the ground should be around **2 CM** while be doing the search to reach as much depth as possible.

The device can reach a maximum of **3.5 METERS** underground

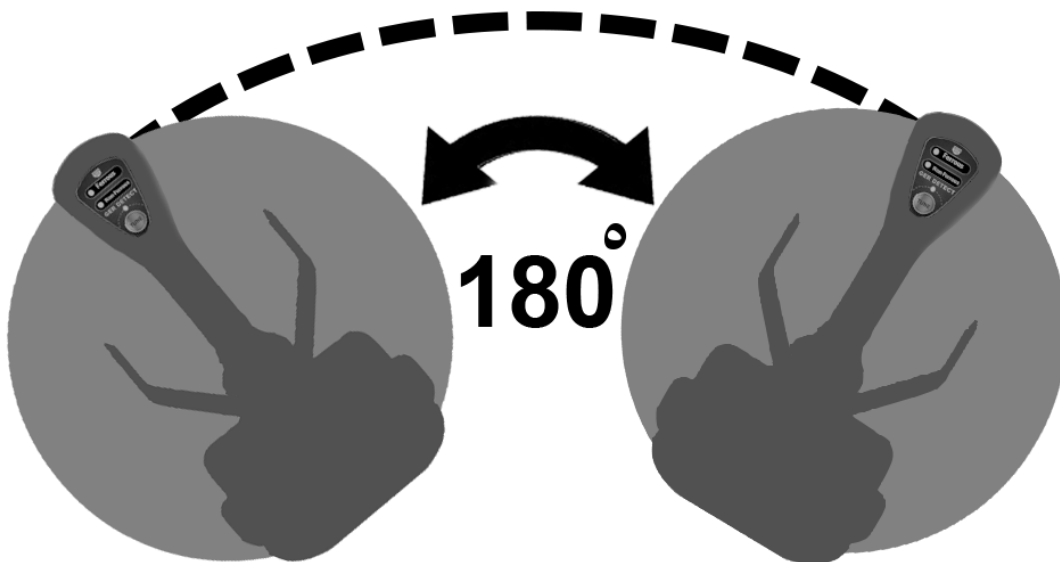

Start the search by moving the device right and left at a normal speed

THE GOLD SEEKER DEVICE OPERATION STEPS

Press on the tune button to increase the depth
Of the device, in case of finding the very deep target.

When you get very low sound this indicates a
Presence of target

Press on the tune button to get a stronger signal

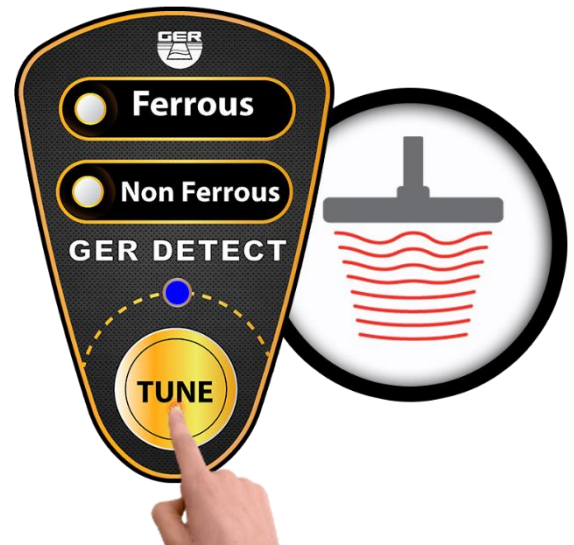

NONFERROUS: when the device detects precious
Metal such as (GOLD, BRONZE, SILVER, ETC.)
The green light will turn on with Continuous sound.



FERROUS: when the device detects non-precious
Metal such as (IRON, STEEL, ETC.)
The red light will turn on with the discontinuous sound



THE GOLD SEEKER DEVICE USING WARNINGS

Don't keep the coil close to your body while searching.

Don't wear any metals on your hand.

Don't put any type of metals in your pocket

For example, (coins, keys), or mobile phone.



Avoid the continuous friction of the coil with the ground and rocks.



THE DEVICE PARTS AND ACCESSORIES



SAFTY BAG



**MAIN UNITE
COIL HOLDER**



**SEARCH COIL
28 CM**

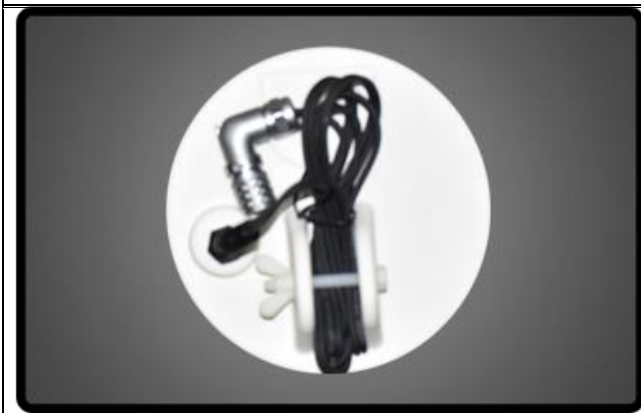

**SEARCH COIL
15 CM**



HEADPHONES



BATTERY



CHARGER



GOLD SEEKER



SHOP DETECTORS
TEL : +1 206-401-9788
WEB : <https://shopdetectors.com/>
EMAIL : contact@shopdetectors.com



UIG DETECTORS
WWW.UIGDETECTORS.COM

GER DETECT
WWW.GERDETECT.DE